

UNIVERSAL PROTRACTOR

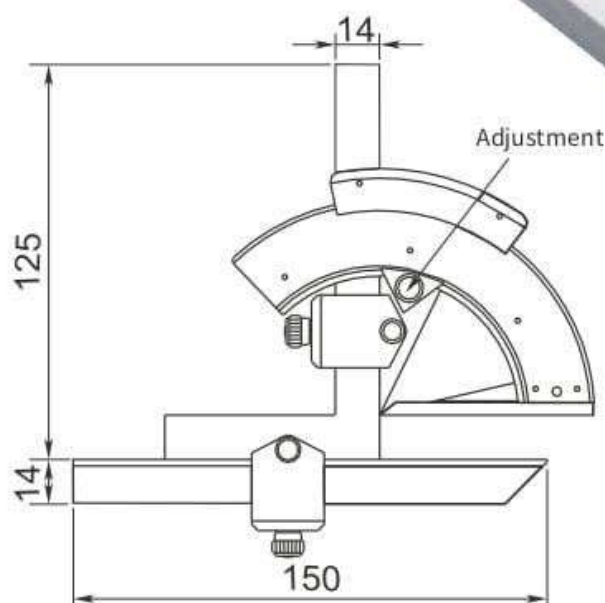
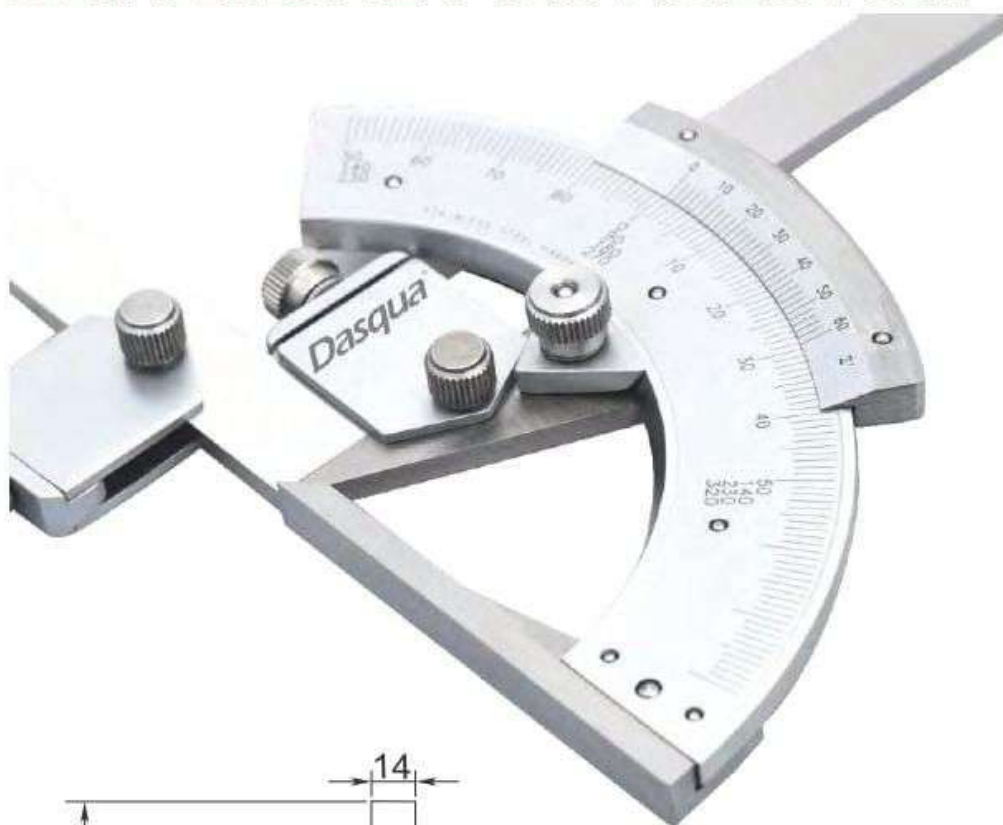

- Made of stainless steel
- With fine adjustment
- Measuring surface hardened, ground and lapped ensures smooth movement
- Satin chrome finish, anti-rust and durable

Unit:mm

| Code | Range | Graduation | Accuracy |
|-----------|--------|------------|----------|
| 1012-2005 | 0-320° | 2' | ±2' |